

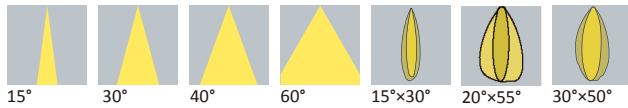

Datasheet

BCQ Series

Available Distribution



Dimensions

Part Number	Diameter	Height
LL01CR-BCQxxL06-Mx	Ø38.1	20.9
LL01ED-BCQxxL06-Mx	Ø38.1	20.2
LL01AA-BCQxxL06-Mx	Ø38.1	20.2

*All dimensions are in millimeters.

LED



Packaging Details (SPQ)

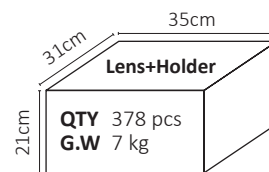

Recommand Applications



General Information

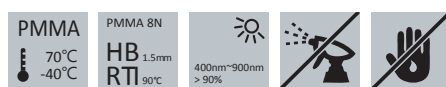

Accessories



- Lens Material PMMA 8N
- Operating Temperature -40°C~+70°C
- UL Flammability HB @1.5mm
- UL RTI Elec 90°C @1.5mm
- Light Transmission Rate 400nm~900nm > 90%
- ☑ If necessary, Clean lenses with mild soap, water and soft cloth.
- ⚠ Never use any commercial cleaning solvents on lenses, like alcohol.
- 🧤 Please handle or install lenses with wearing gloves, skin oils may damage lens or its optical characteristic.

- 3 Different Types of Holder
LL01CRRB15Hx
LL01EDQE25Hx
LL01EDAAI25Hx

Mechanical Specification

*All dimensions are in millimeters.

Lens Dimension

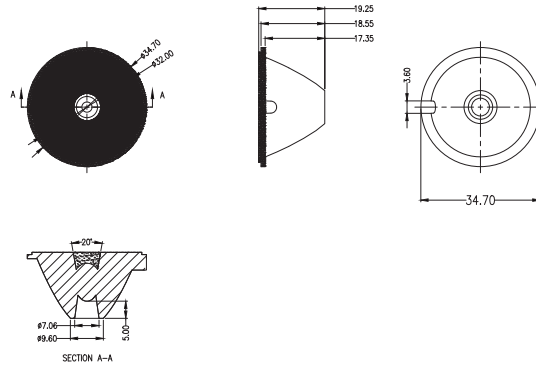

Holder Dimension

LL01CRRB15Hx

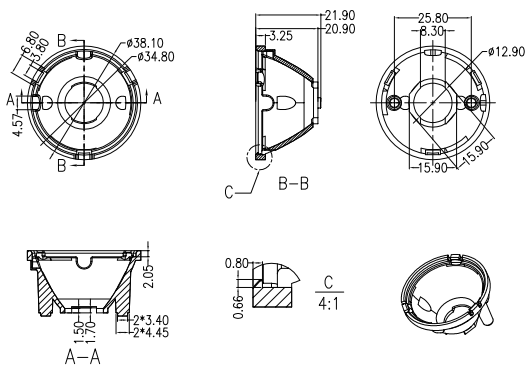

Assembly Instruction

Part No LL01CR-BCQxxL06-Mx
Holder LL01CRRB15Hx

Fixing Method



Luminarie
Accessories

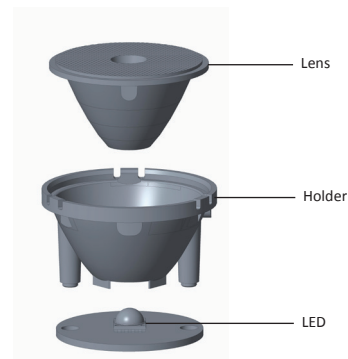

Holder Dimension

LL01EDQE25Hx

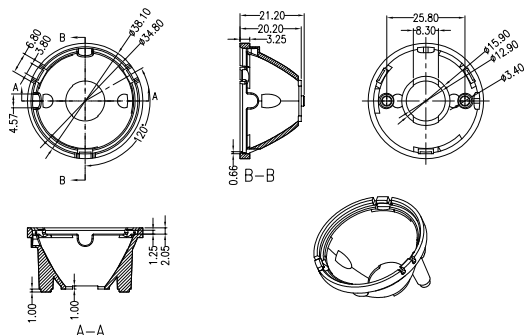

Assembly Instruction

Part No LL01ED-BCQxxL06-Mx
Holder LL01EDQE25Hx

Fixing Method



Luminarie
Accessories

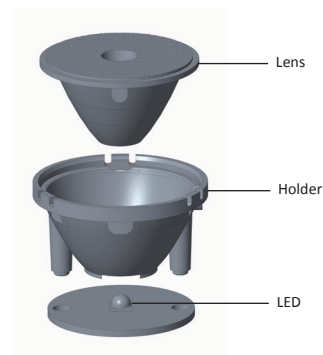

Mechanical Specification

*All dimensions are in millimeters.

Holder Dimension



LL01EDAAI25Hx

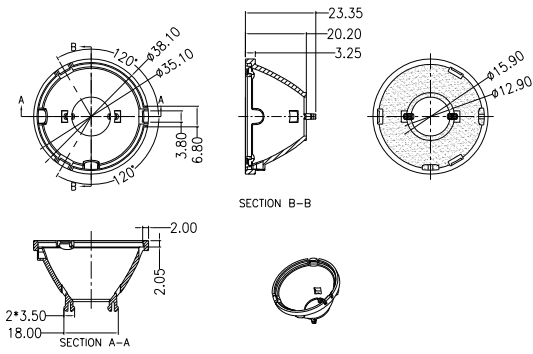

Assembly Instruction

Fixing Method

Part No LL01AA-BCQxxL06-Mx
Holder LL01EDAAI25Hx

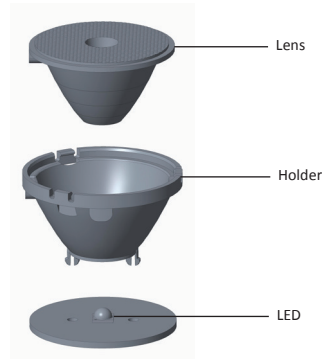

Photometric Distribution



CREE
MC-E (RGBW)



CREE
XM-L Color









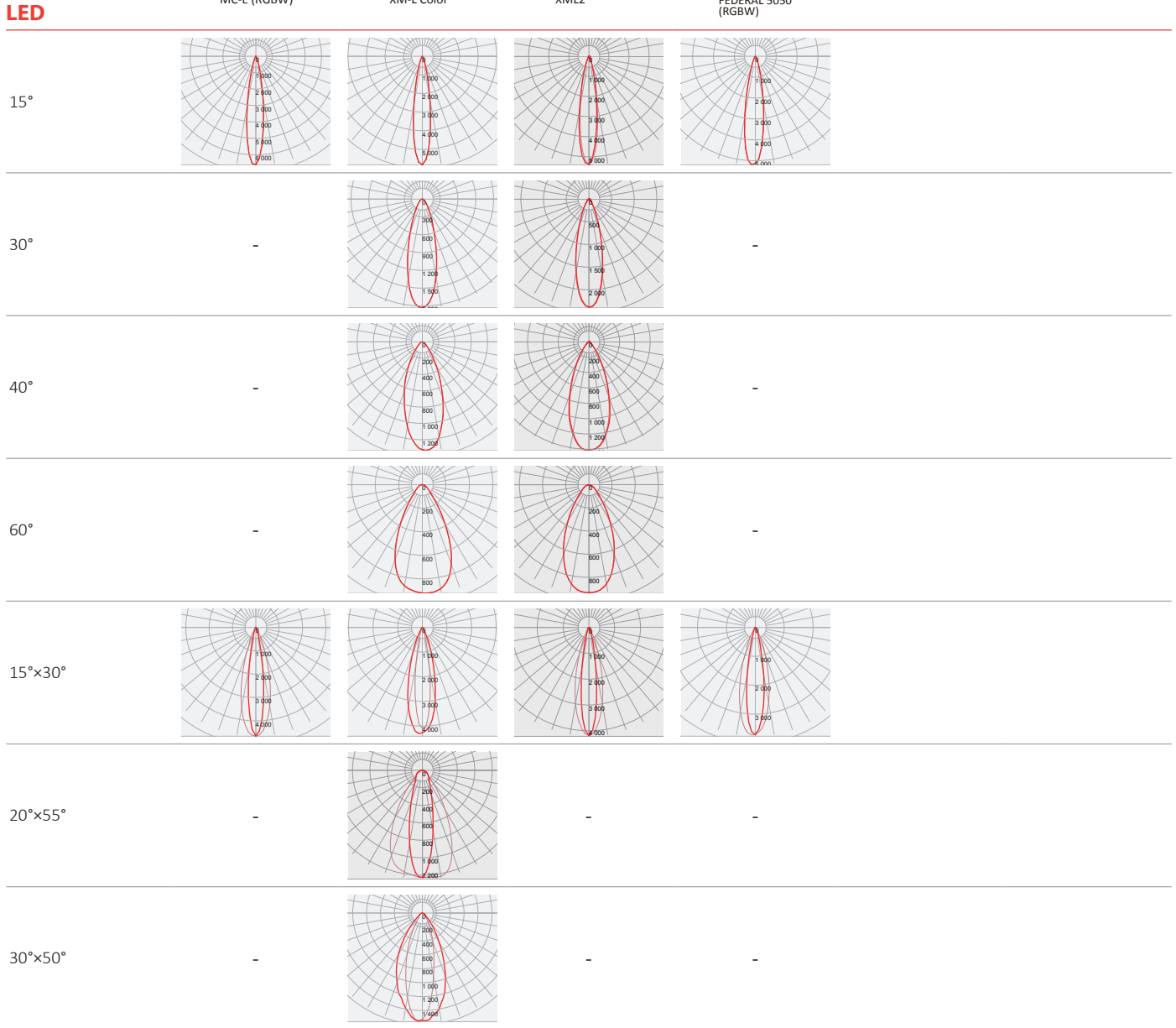

CREE
XML2

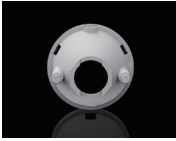

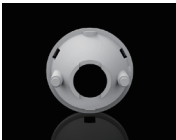

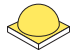























EDISON
FEDERAL 5050
(RGBW)



Details by LED

Part No	Holder	LED Package Size	LED
LL01CR-BCQxxL06-Mx	 LL01CRRB15Hx	7090	 CREE MC-E (RGBW)
LL01ED-BCQxxL06-Mx	 LL01EDQE25Hx	5050	   CREE XM-L Color CREE XML2 EDISON FEDERAL 5050 (RGBW)
LL01AA-BCQxxL06-Mx	 LL01EDAAI25Hx	5050	 CREE XM-L Color

LED	Part No	FWHM	cd / lm	IES
 CREE MC-E (RGBW)	LL01CR-BCQ15L06-M1	17°	6.6	
	LL01CR-BCQ30L06-M1	-	-	-
	LL01CR-BCQ40L06-M1	-	-	-
	LL01CR-BCQ60L06-M1	-	-	-
	LL01CR-BCQ1530L06-M1	16°x29°	4.6	
	LL01CR-BCQ2055L06-M1	-	-	-
	LL01CR-BCQ3050L06-M1	-	-	-
 CREE XM-L Color	LL01AA-BCQ15L06-M2	17°	5.8	
	LL01AA-BCQ30L06-M2	30°	1.9	
	LL01AA-BCQ40L06-M2	40°	1.3	
	LL01AA-BCQ60L06-M2	54°	0.9	
	LL01AA-BCQ1530L06-M2	28°x17°	4.4	
	LL01AA-BCQ2055L06-M2	25°x58°	1.2	
	LL01AA-BCQ3050L06-M2	51°x30°	1.4	
	LL01ED-BCQ15L06-M2	17°	5.8	
	LL01ED-BCQ30L06-M2	30°	1.8	
	LL01ED-BCQ40L06-M2	40°	1.3	
	LL01ED-BCQ60L06-M2	54°	0.9	
	LL01ED-BCQ1530L06-M2	28°x17°	4.4	
	LL01ED-BCQ2055L06-M2	25°x58°	1.2	
	LL01ED-BCQ3050L06-M2	51°x30°	1.5	
 CREE XML2	LL01ED-BCQ15L06-M1	18°	5.3	
	LL01ED-BCQ30L06-M1	28°	2.3	
	LL01ED-BCQ40L06-M1	41°	1.4	
	LL01ED-BCQ60L06-M1	52°	0.9	
	LL01ED-BCQ1530L06-M1	16°x28°	4.1	
	LL01ED-BCQ2055L06-M2	-	-	-
	LL01ED-BCQ3050L06-M1	-	-	-

LED	Part No	FWHM	cd / lm	IES
 EDISON FEDERAL 5050 (RGBW)	LL01ED-BCQ15L06-M1	19°	5.1	
	LL01ED-BCQ30L06-M1	-	-	-
	LL01ED-BCQ40L06-M1	-	-	-
	LL01ED-BCQ60L06-M1	-	-	-
	LL01ED-BCQ1530L06-M1	18°x30°	3.7	
	LL01ED-BCQ2055L06-M1	-	-	-
	LL01ED-BCQ3050L06-M1	-	-	-

Product Nomenclature

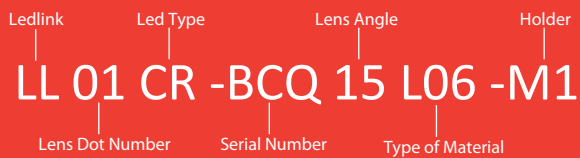

Ledlink Optics, Inc Taiwan HQ

15F, No.655, Bannan Rd., Chung-Ho Dist.,
New Taipei City, Taiwan 235

Ledlink Optics (Dongguan) Co., Ltd Dongguan Factory

No.6, Gaoxin Road, Tiankeng, Hengli Town, Dongguan City,
Guangdong Province, China 523478

Ledlink Optics (Yangzhou) Co., Ltd Yangzhou Factory

No.180, LinJiang Rd., Yangzhou City, Jiangsu Province, China 225009

www.ledlink-optics.com

service@ledlink-optics.com

