

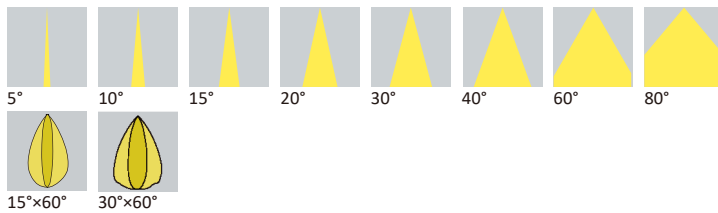

Datasheet

# AHA Series

## Available Distribution



## LED

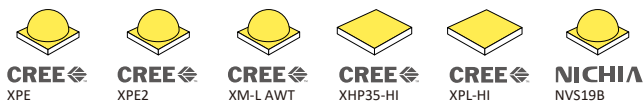

## Recommend Applications



## General Information

PMMA 70°C -40°C	PC 110°C -40°C	PMMA 8N HB 1.5mm RTI 90°C	PC LUX 2180T V-2 1.5mm RTI 130°C	400nm~900nm >90%		
-----------------------	----------------------	---------------------------------	--	---------------------	--	--

- Lens Material L06:PMMA 8N / L52: PC LUX2180T
- Operating Temperature PMMA:-40°C~+70°C / PC:-40°C~+110°C
- UL Flammability L06:HB / L52:V-2 @1.5mm
- UL RTI Elec L06:90°C / L52:130°C@1.5mm
- Light Transmission Rate 400nm~900nm > 90%
- ⚠ If necessary, Clean lenses with mild soap, water and soft cloth.
- ⚠ Never use any commercial cleaning solvents on lenses, like alcohol.
- ⚠ Please handle or install lenses with wearing gloves, skin oils may damage lens or its optical characteristic.

## Dimensions

Part Number	Diameter	Height
LL01ZZ-AHA05L06-M2-T	Ø52	27
LL01ZZ-AHA10L06-M2-T		
LL01ZZ-AHA05L06-M2-T + LL01ZZ-DCKxxL52		

\*All dimensions are in millimeters.

## Packaging Details (SPQ)

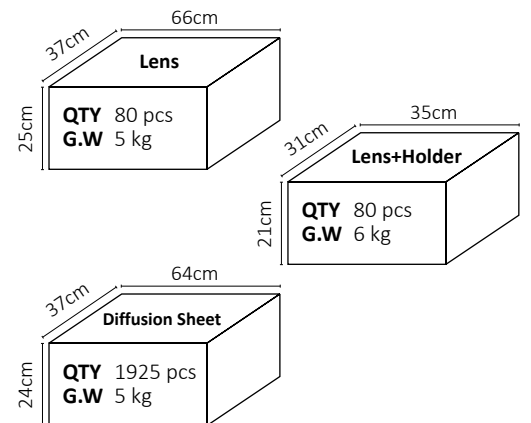

## Accessories



- Available with Holder LL01CRRN05H2
- Available with Diffusion Sheet LL01ZZ-DCKxxL52
- Available with Tape LL01A33AXVXX

# Mechanical Specification

\*All dimensions are in millimeters.

## Lens Dimension

LL01ZZ-AHA××L06

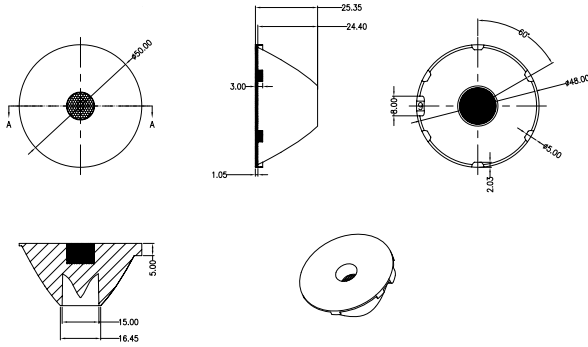

## Holder Dimension

LL01CRRN05H2

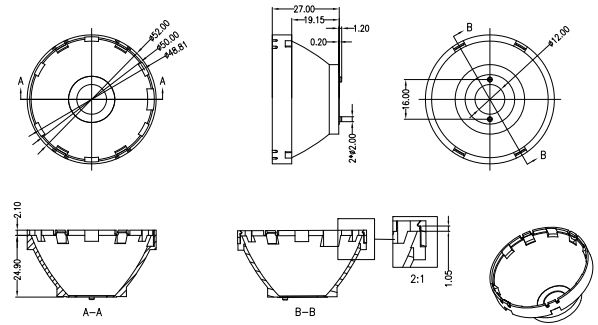

## Tape Dimension

LL01A33AXVXX

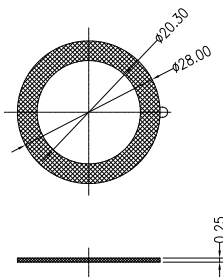

## Assembly Instruction

Part No LL01ZZ-AHA××L06-M2-T  
Holder LL01CRRN05H2  
Tape LL01A33AXVXX

Fixing Method

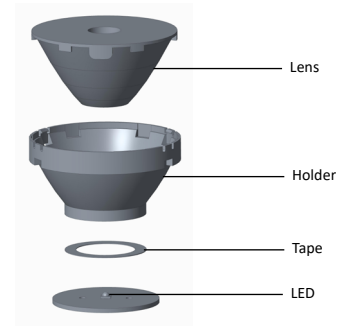
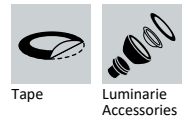

## Diffusion Sheet Dimension

LL01ZZ-DCK××L52

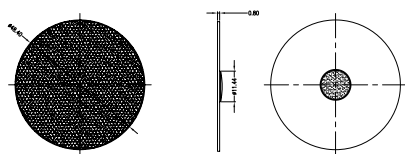

## Assembly Instruction

Part No LL01ZZ-AHA05L06-M2-T  
+ LL01ZZ-DCK××L52  
Holder LL01CRRN05H2  
Diffusion Sheet LL01ZZ-DCK××L52  
Tape LL01A33AXVXX

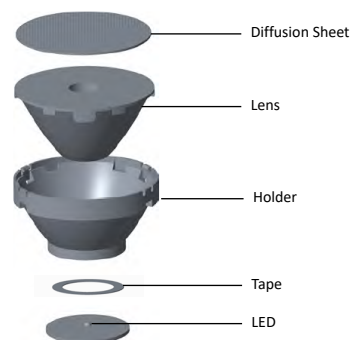
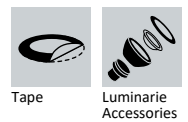

Fixing Method



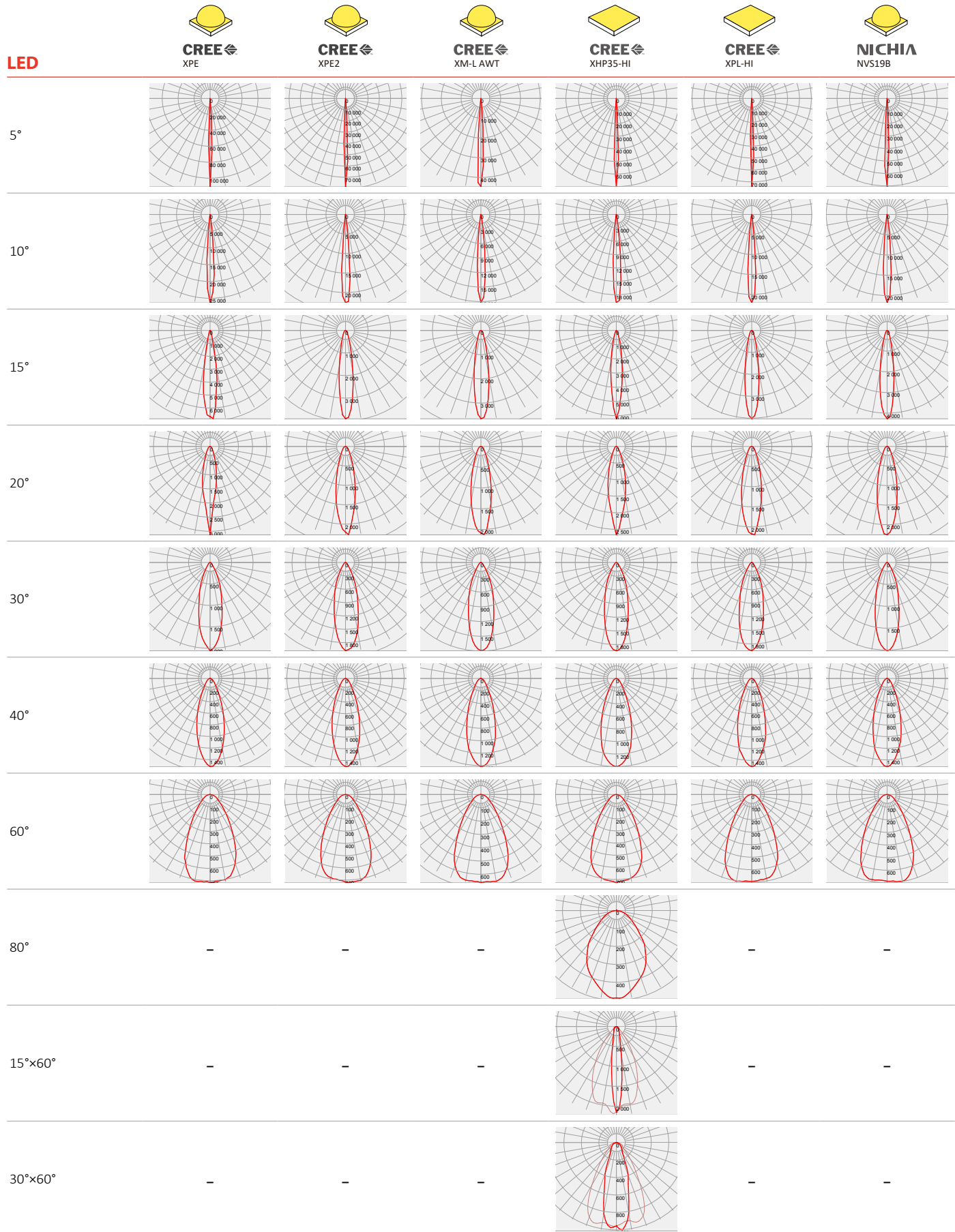

# Photometric Distribution

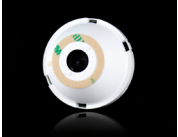

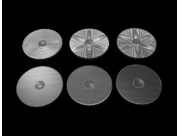















# Details by LED

Part No	Holder	Tape	Diffusion Sheet	LED Package Size
LL01ZZ-AHAxxL06-M2-T	 LL01CRRN05H2	 LL01A33AXVXX	-	3535 / 5050
LL01ZZ-AHA05L06-M2-T + LL01ZZ-DCKxxL52	 LL01CRRN05H2	 LL01A33AXVXX	 LL01ZZ-DCKxxL52	

LED	Part No	FWHM	cd/lm	IES
	LL01ZZ-AHA05L06-M2-T	4°	110.5	<a href="#">↓</a>
	LL01ZZ-AHA05L06-M2-T + LL01ZZ-DCK10L52	9°	26.3	<a href="#">↓</a>
	LL01ZZ-AHA05L06-M2-T + LL01ZZ-DCK15L52	17°	6.8	<a href="#">↓</a>
	LL01ZZ-AHA05L06-M2-T + LL01ZZ-DCK20L52	16°	3.1	<a href="#">↓</a>
	LL01ZZ-AHA05L06-M2-T + LL01ZZ-DCK30L52	30°	2.0	<a href="#">↓</a>
	LL01ZZ-AHA05L06-M2-T + LL01ZZ-DCK40L52	35°	1.5	<a href="#">↓</a>
	LL01ZZ-AHA05L06-M2-T + LL01ZZ-DCK60L52	59°	0.7	<a href="#">↓</a>
	LL01ZZ-AHA05L06-M2-T	4°	78.2	<a href="#">↓</a>
	LL01ZZ-AHA05L06-M2-T + LL01ZZ-DCK10L52	9°	22.5	<a href="#">↓</a>
	LL01ZZ-AHA05L06-M2-T + LL01ZZ-DCK15L52	18°	3.9	<a href="#">↓</a>
	LL01ZZ-AHA05L06-M2-T + LL01ZZ-DCK20L52	25°	2.2	<a href="#">↓</a>
	LL01ZZ-AHA05L06-M2-T + LL01ZZ-DCK30L52	31°	1.9	<a href="#">↓</a>
	LL01ZZ-AHA05L06-M2-T + LL01ZZ-DCK40L52	36°	1.5	<a href="#">↓</a>
	LL01ZZ-AHA05L06-M2-T + LL01ZZ-DCK60L52	60°	0.7	<a href="#">↓</a>

LED	Part No	FWHM	cd/lm	IES
	LL01ZZ-AHA05L06-M2-T	6°	44.6	<a href="#">↓</a>
	LL01ZZ-AHA05L06-M2-T + LL01ZZ-DCK10L52	10°	18.2	<a href="#">↓</a>
	LL01ZZ-AHA05L06-M2-T + LL01ZZ-DCK15L52	19°	3.6	<a href="#">↓</a>
	LL01ZZ-AHA05L06-M2-T + LL01ZZ-DCK20L52	26°	2.1	<a href="#">↓</a>
	LL01ZZ-AHA05L06-M2-T + LL01ZZ-DCK30L52	33°	1.7	<a href="#">↓</a>
	LL01ZZ-AHA05L06-M2-T + LL01ZZ-DCK40L52	37°	1.4	<a href="#">↓</a>
	LL01ZZ-AHA05L06-M2-T + LL01ZZ-DCK60L52	62°	0.6	<a href="#">↓</a>
	LL01ZZ-AHA05L06-M2-T	5°	70.0	<a href="#">↓</a>
	LL01ZZ-AHA05L06-M2-T + LL01ZZ-DCK10L52	9°	19.7	<a href="#">↓</a>
	LL01ZZ-AHA05L06-M2-T + LL01ZZ-DCK15L52	15°	6.2	<a href="#">↓</a>
	LL01ZZ-AHA05L06-M2-T + LL01ZZ-DCK20L52	23°	2.6	<a href="#">↓</a>
	LL01ZZ-AHA05L06-M2-T + LL01ZZ-DCK30L52	31°	1.9	<a href="#">↓</a>
	LL01ZZ-AHA05L06-M2-T + LL01ZZ-DCK40L52	39°	1.4	<a href="#">↓</a>
	LL01ZZ-AHA05L06-M2-T + LL01ZZ-DCK60L52	60°	0.7	<a href="#">↓</a>
	LL01ZZ-AHA05L06-M2-T + LL01ZZ-DCK80L52	79°	0.4	<a href="#">↓</a>
	LL01ZZ-AHA05L06-M2-T + LL01ZZ-DCK1560L52	14°x56°	2.2	<a href="#">↓</a>
	LL01ZZ-AHA05L06-M2-T + LL01ZZ-DCK3060L52	31°x63°	1.0	<a href="#">↓</a>

LED	Part No	FWHM	cd/lm	IES
	LL01ZZ-AHA05L06-M2-T	4°	73.9	
	LL01ZZ-AHA05L06-M2-T + LL01ZZ-DCK10L52	9°	22.0	
	LL01ZZ-AHA05L06-M2-T + LL01ZZ-DCK15L52	18°	4.0	
	LL01ZZ-AHA05L06-M2-T + LL01ZZ-DCK20L52	26°	2.1	
	LL01ZZ-AHA05L06-M2-T + LL01ZZ-DCK30L52	31°	1.9	
	LL01ZZ-AHA05L06-M2-T + LL01ZZ-DCK40L52	36°	1.5	
	LL01ZZ-AHA05L06-M2-T + LL01ZZ-DCK60L52	60°	0.7	
	LL01ZZ-AHA05L06-M2-T	5°	70.5	
	LL01ZZ-AHA10L06-M2-T	7°	32.6	
	LL01ZZ-AHA05L06-M2-T + LL01ZZ-DCK10L52	9°	21.7	
	LL01ZZ-AHA05L06-M2-T + LL01ZZ-DCK15L52	18°	4.2	
	LL01ZZ-AHA05L06-M2-T + LL01ZZ-DCK20L52	26°	2.2	
	LL01ZZ-AHA05L06-M2-T + LL01ZZ-DCK30L52	30°	2.0	
	LL01ZZ-AHA05L06-M2-T + LL01ZZ-DCK40L52	36°	1.5	
	LL01ZZ-AHA05L06-M2-T + LL01ZZ-DCK60L52	61°	0.6	

## Product Nomenclature

Ledlink    Led Type    Lens Angle    Holder    Diffusion Sheet Angle

**LL 01 ZZ -AHA 05 L06 -M2 -T + LL01ZZ-DCK10L52**

Lens Dot Number    Serial Number    Type of Material    Tape

### Ledlink Optics, Inc

Taiwan HQ

15F, No.655, Bannan Rd., Chung-Ho Dist.,  
New Taipei City, Taiwan 235

### Ledlink Optics (Dongguan) Co., Ltd

Dongguan Factory

No.6, Gaoxin Road, Tiankeng, Hengli Town, Dongguan City,  
Guangdong Province, China 523478

### Ledlink Optics (Yangzhou) Co., Ltd

Yangzhou Factory

No.180, LinJiang Rd., Yangzhou City, Jiangsu Province, China 225009

[www.ledlink-optics.com](http://www.ledlink-optics.com)

[service@ledlink-optics.com](mailto:service@ledlink-optics.com)

